

2023-10-05 12:06:01 PM

C:\Users\lauren.mackenzie\Desktop\00 Lake Country MASTER SITE Revit 23.rvt



1 LANDSCAPE PLAN
DPL1 1 : 300

- FEATURE LEGEND**
- N-01 NATURALIZED GRASSLAND
 - N-02 AMENITY SPACE W/ PERGOLAS, BBQS, MOVEABLE PLANTERS, OUTDOOR FURNITURE, CATENARY LIGHTS
 - N-03 NATURAL AMENITY SPACE W/ SEATING BOULDERS
 - N-04 HWY 97 LANDSCAPE TO REMAIN UNDISTURBED
 - N-05 AMENITY SPACE W/ PERGOLAS, BBQS, MOVEABLE PLANTERS, OUTDOOR FURNITURE, CATENARY LIGHTS
 - N-06 LAWN AMENITY W/ BENCH
 - N-07 MULTI-USE LAWN SPACE
 - N-08 RAISED COMMUNITY GARDENS W/ 2 BENCHES
 - N-09 TERRACED RETAINING WALLS - REFER TO CIVIL
 - N-10 BIKE RACKS - 2 / RACK = 24 TOTAL
 - N-11 1.2m HT OPAQUE WOOD FENCE

- LEGEND**
- 150MM TO 300MM RIVERSTONE
 - NATIVE SEED
 - LESS WATER SOD
 - DECORATIVE BOULDERS
 - BOULDER RETAINING WALL REFER TO CIVIL (1.5M HEIGHTS)
 - MODULAR PLANTER WALL BARKMAN ARCHITECTURES 1200MM HT
 - RETAINING WALL - REFER TO CIVIL
 - GREY LIGHT BROOM FINISH CONCRETE WALKWAY
 - SHREDED WOOD BARK MULCH
 - BIKE RACK
 - ARMSTRONG MAPLE 4 @ 60MM CAL.
 - RED MAPLE 16 @ 60MM CAL.
 - SWEDISH COLUMNAR ASPEN 5 @ 60MM CAL.
 - LODGEPOLE PINE 48 @ 2.5M HT.
 - COLORADO BLUE SPRUCE 16 @ 2.5M HT.
 - PONDEROSA PINE 7 @ 2.5M HT.
 - EXISTING TREES TO REMAIN

CONIFEROUS
Less than 3.0m height
Spade Hole Preparation for Basket or Ball & Burlap Trees

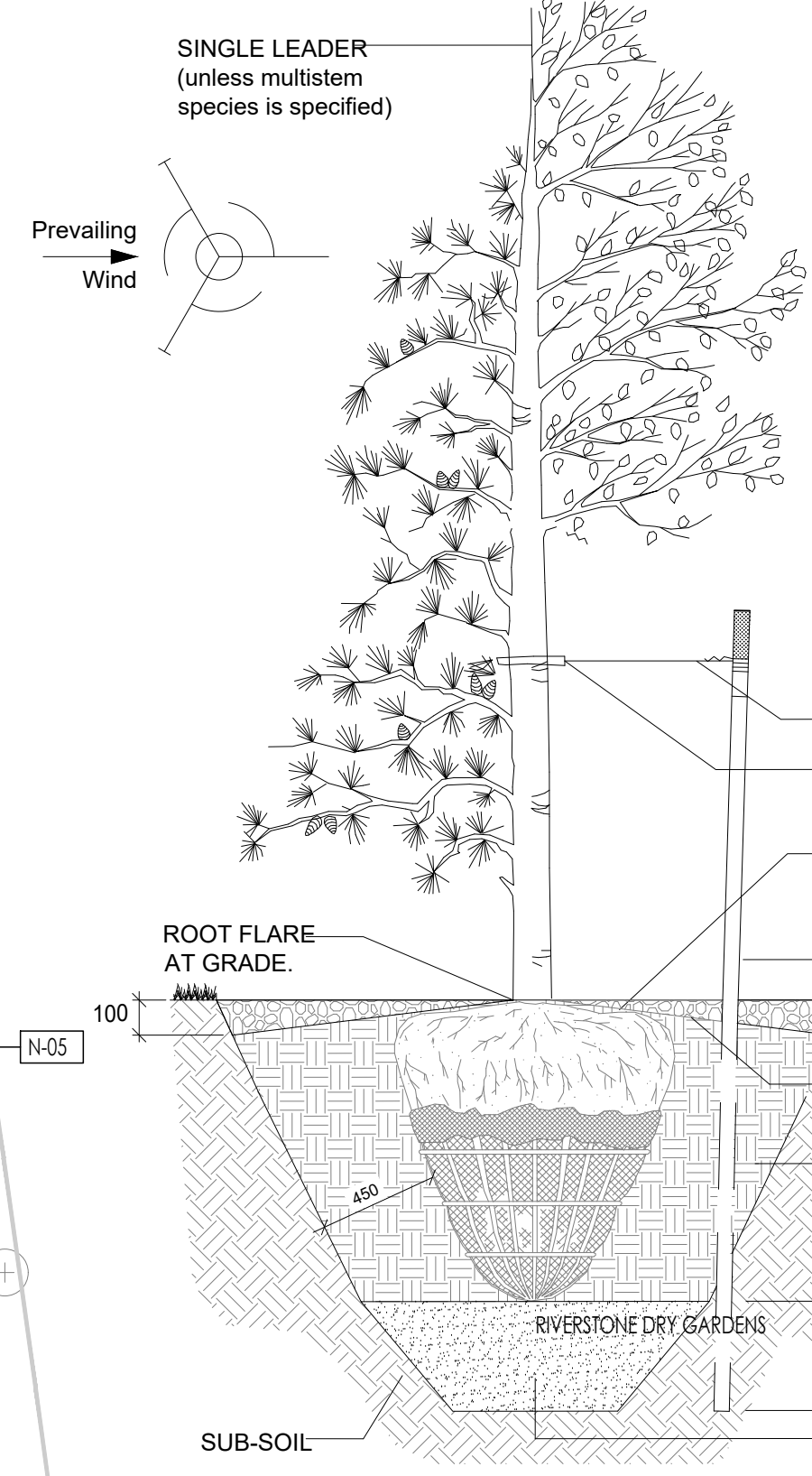

2 TREE PLANTING DETAIL
L01 1 : 25

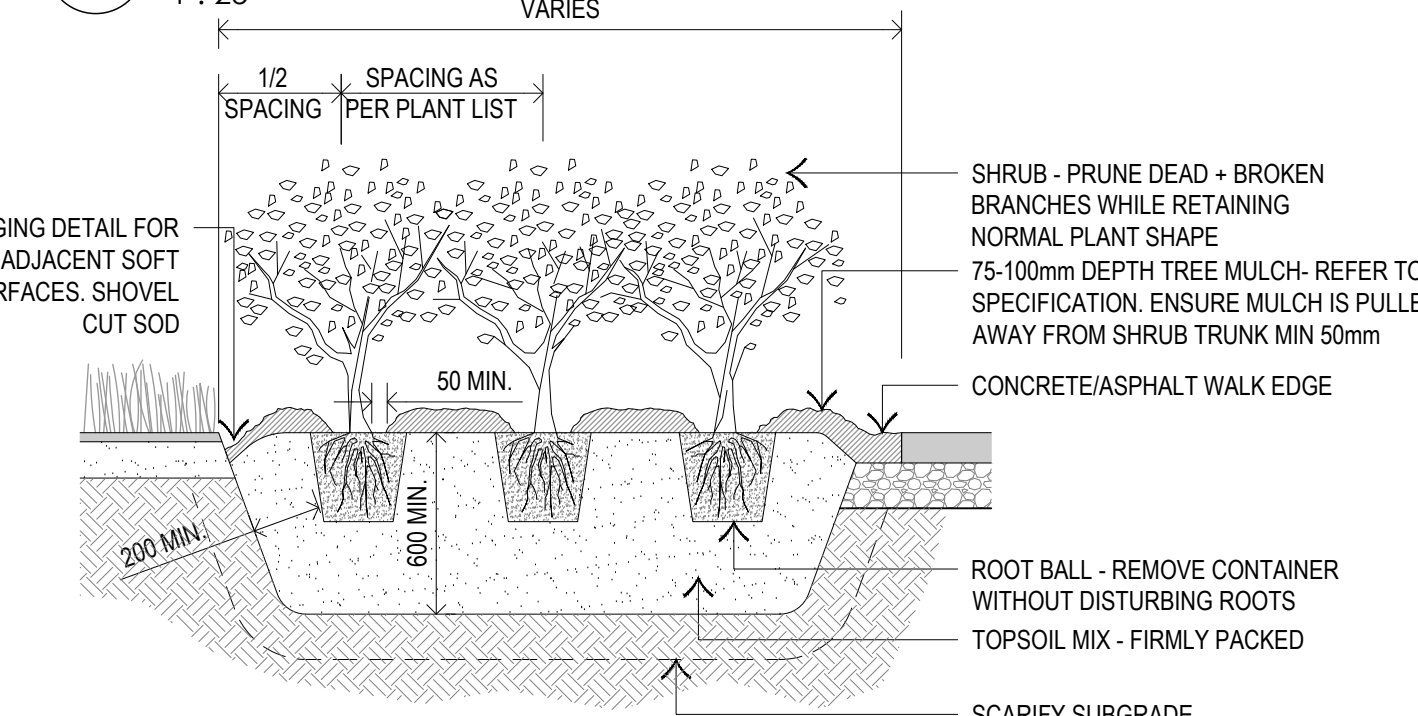

3 SHRUB PLANTING DETAIL
L01 1 : 25

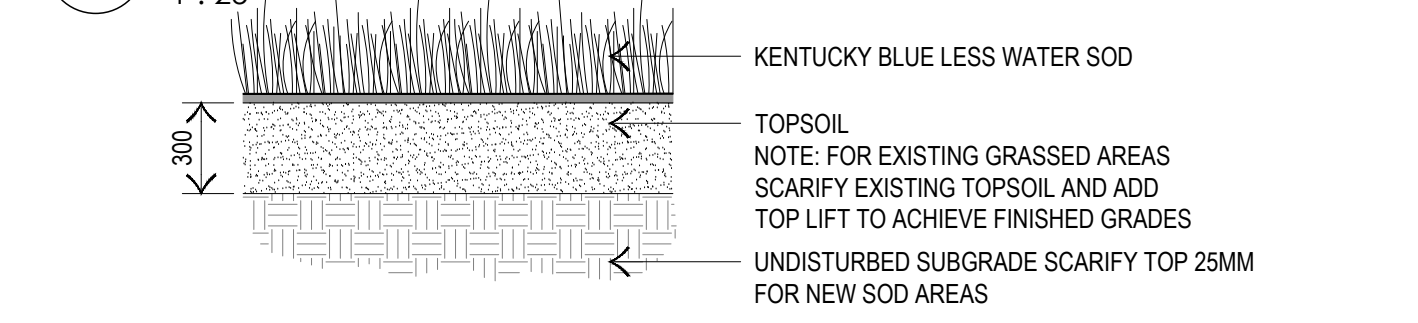

4 SOD / SEED DETAIL
L01 1 : 25

- NOTES:**
1. DO NOT ALLOW AIR POCKETS TO FORM WHEN BACK FILLING.
 2. STAKE BEYOND EDGE OF ROOT BALL.
 3. TREE SHOULD BE PLANTED 75mm-100mm BELOW GROUND LEVEL.
 4. T-BARS SHOULD BE HAMMERED DOWN INTO SOLID FOOTING (AT LEAST 400mm INTO SUB-SOIL BASE).
 5. IF TREE IS IN WIRE BASKET, CUT AND REMOVE STRAPPING AND THE HORIZONTAL/VERTICAL WIRES OF THE WIRE BASKET TO A MINIMUM DEPTH OF 200mm FROM THE TOP OF THE ROOT BALL. PULL BACK BURLAP TO THIS SAME MINIMUM DEPTH.
 6. USE RUBBER STRAPS AT ENDS OF ALL GUY WIRES TO PROTECT THE TREE AT POINT OF CONTACT.
 7. PRUNE DEAD BRANCHES TO MAINTAIN NATURAL FORM OF TREE.
- 11 GAUGE GUY WIRE.
 - RUBBER STRAP. WIRE DOES NOT GO AROUND TREE.
 - MULCH, STARTING 50mm FROM ROOT FLARE (TRUNK) & EXTENDING THE HOLE.
 - USE THREE 1800mm PAINTED T-BARS. (staking optional)
 - SLOPE TOPSOIL FROM ROOT BALL TO EDGE OF HOLE TO FORM WELL.
 - TOP SOIL, REFER TO TOP SOIL SPECS.

GENERAL NOTES
This drawing and all its contents are protected by copyright, and shall not be reproduced, in whole or in part without the expressed written consent of Casola Koppe Architects Ltd. These drawings are not to be scaled. All dimensions are to face of stud or sheathing unless noted otherwise. Contractor must verify all dimensions, drawings, details and specifications. Any discrepancies are to be reported to Casola Koppe Architects Ltd. prior to proceeding with work; this includes any errors or omissions.

Revision Schedule

Number	Date (yy/mm/dd)	Description
1	2022 05 03	ISSUED FOR DP
2	2023 09 08	ISSUED FOR COORDINATION
3	2023 10 05	ISSUED FOR COORDINATION
4	2023 10 23	RE-ISSUED FOR DP

LANDSCAPE GENERAL NOTES

- ALL LANDSCAPE CONSTRUCTION, INCLUDING ALL HARD AND SOFT LANDSCAPING, TO BE CONSTRUCTED IN ACCORDANCE WITH LAKE COUNTRY LANDSCAPE STANDARDS
- ALL TREES AND SHRUBS TO BE RETAINED SHALL BE PROTECTED DURING ALL PHASES OF CONSTRUCTION.
- ALL PLANT MATERIAL SHALL MEET THE STANDARDS OF THE CANADIAN NURSERY TRADES ASSOCIATION AND BE TRUE TO TYPE AND SPECIES
- ALL PLANT MATERIAL SHALL BE LOCALLY GROWN BRITISH COLUMBIA NURSERY STOCK.
- ALL PLANT MATERIAL TO BE LOCATED WITHIN MULCHED PLANTING BEDS OR INDIVIDUAL MULCHED TREE WELLS
- ALL PLANTING BEDS TO HAVE A MIN. 75mm DEPTH BARK MULCH
- ALL LANDSCAPE AREAS TO BE EQUIPPED WITH A FULLY AUTOMATIC HIGH EFFICIENCY IRRIGATION SYSTEM.
- CONTRACTOR TO ENSURE THE LOCATION FOR ALL UNDERGROUND UTILITIES ARE MARKED PRIOR TO ANY WORK OF THIS CONTACT - CALL ALBERTA 1ST CALL (1-800-242-3447)

CONSULTANT
[SMM]

STAMP

ARCHITECT
casola koppe
ARCHITECTS
#300 - 1410 1st SW, Calgary, Alberta T2R 0V8
bus: (403) 287-9960 fax: (403) 287-9962 info@ckarch.ca

PROJECT NAME AND ADDRESS
LAKE COUNTRY
11474 PETRIE ROAD
LAKE COUNTRY, BC, V4V 1Z9
LOT S3, PLAN KAP444

DRAWING
LANDSCAPE PLAN

DRAWN BY JOB NO. Building Permit #

CHECKED BY SHEET

ISSUE DATE (yy/mm)

SCALE AS NOTED

DPL1