

Grading & Drainage:
 All grades within the lot 10 feet adjacent from a structure must have a 5% slope on previous surfaces and a 2% slope on impervious surfaces.
 Runoff as a result of grading and drainage activities associated with this project must be contained on-site and shall not overflow to an adjacent property.

USE THE FOLLOWING DRAWING IN CONJUNCTION WITH THE CLIENT PROVIDED SITE PLAN. REFER TO BOUNDARY & TOPOGRAPHIC SURVEY DRAWINGS FOR DETAILED INFORMATION

LEGAL / SITE DESCRIPTION	
OSOYOOS, BRITISH COLUMBIA	
ADDRESS	30 CRYSTAL WATERS, LAKE COUNTRY, BC
COMMUNITY	OSOYOOS DIVISION YALE DISTRICT
STRATA PLAN	KAS2946
LOT	LOT 30, SECTION 24, TOWNSHIP 14
ZONING	-
EXISTING LOT AREA	-

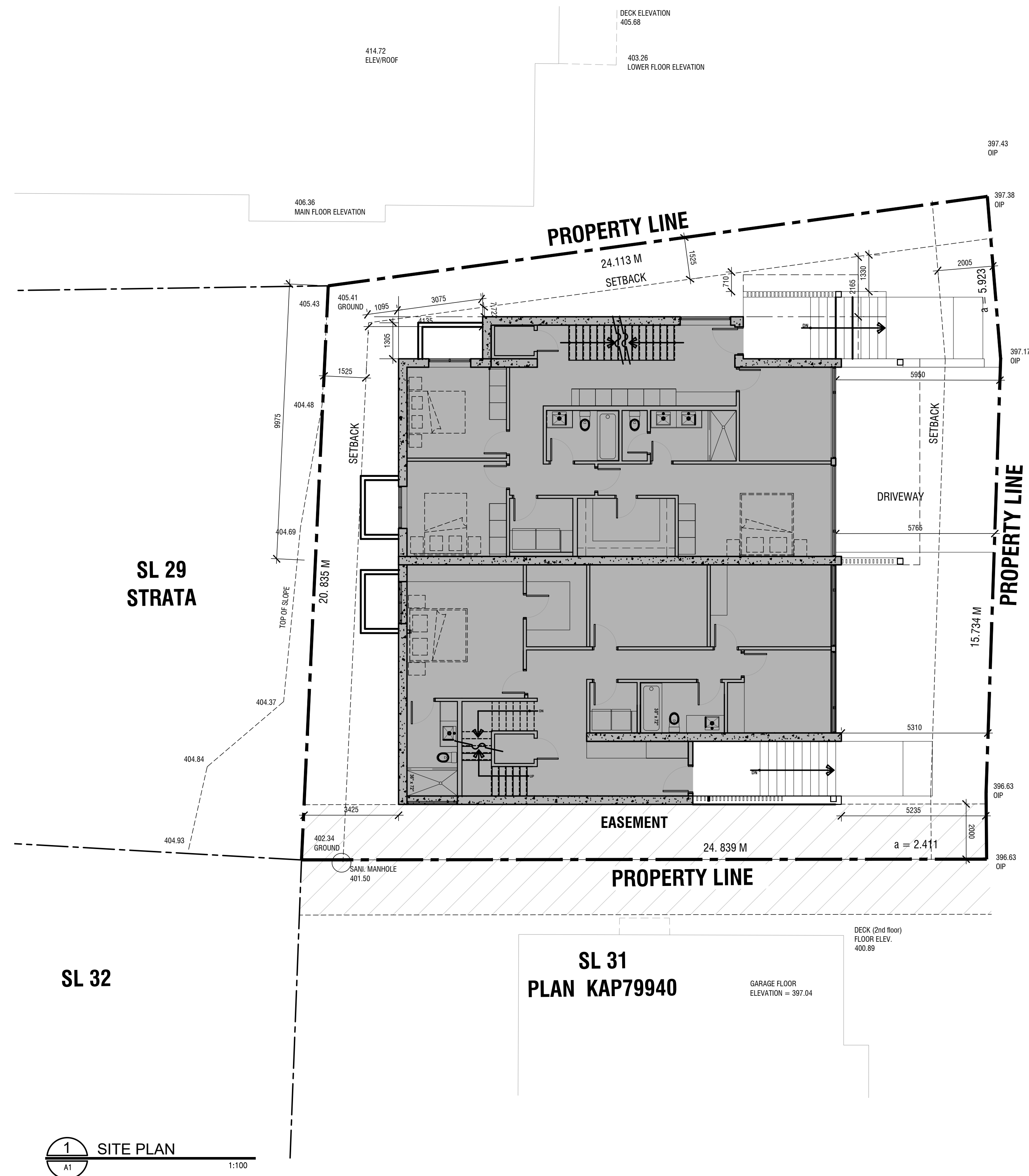

Effective Insulation Assemblies		
EFFECTIVE RSI (R) VALUES FOR ALL ASSEMBLIES WITH OR WITHOUT A HEAT RECOVERY VENTILATOR AS PER BCBC 9.36		
BUILDING ASSEMBLY	BCBC REQUIRED RSI (R) VALUE	REQUIRED RSI (R) VALUE FOR STEP 3 + 20%
CEILINGS BELOW ATTICS	N/A	N/A
CATHEDRAL CEILINGS & FLAT ROOFS	4.67 (R-26.5)	5.60 (R-31.8)
ABOVE GRADE EXTERIOR WALLS	3.08 (R17.5)	3.70 (R-21)
BELOW GRADE FOUNDATION WALLS	2.98 (R16.9)	3.58 (R-20.28)
FLOORS OVER UNHEATED SPACE	4.67 (R-26.5)	5.60 (R-31.8)
UNHEATED FLOOR ABOVE FROSTLINE	1.96 (R-11.1)	2.35 (R-13.32)
FENESTRATION & DOORS	REQUIRED RSI (R) VALUE	STEP 3 + 20%
EXTERIOR DOORS	2.60 (U-0.46)	2.17 (U-0.38)
WINDOWS	1.80 (U-0.32)	1.50 (0.27)
SKYLIGHTS	N/A	N/A
U-VALUES SHALL BE IN COMPLIANCE WITH THE VALUES SPECIFIED IN BCBC 9.36.2.7.A		
EFFECTIVE RSI (R) VALUES FOR ALL ASSEMBLIES		
BUILDING ASSEMBLY	TOTAL EFFECTIVE VALUE	REQUIRED RSI (R) VALUE FOR STEP 3 + 20%
FT1 - UNHEATED FLOOR ABOVE FROSTLINE	3.06 (R-17.4)	2.35 (R-13.32)
FT2 - FLOOR OVER UNHEATED SPACE	6.66 (R-37.8)	5.60 (R-31.8)
FT5 - FLOOR OVER UNHEATED SPACE	5.97 (R-33.9)	5.60 (R-31.8)
RT1 - CATHEDRAL CEILINGS & FLAT ROOFS	6.85 (R-38.9)	5.60 (R-31.8)
RT2 - CATHEDRAL CEILINGS & FLAT ROOFS	6.69 (R38.0)	5.60 (R-31.8)
RT3 - CATHEDRAL CEILINGS & FLAT ROOFS	10.68 (R60.65)	5.60 (R-31.8)
RT4 - CATHEDRAL CEILINGS & FLAT ROOFS	5.71 (R32.4)	5.60 (R-31.8)
RT5 - CATHEDRAL CEILINGS & FLAT ROOFS	5.97 (R-33.9)	5.60 (R-31.8)
WT1 - ABOVE GRADE EXTERIOR WALLS	4.79 (R-27.2)	3.70 (R-21)
WT2 - ABOVE GRADE EXTERIOR WALLS	4.02 (R22.83)	3.70 (R-21)
WT3 - ABOVE GRADE EXTERIOR WALLS	5.59 (R31.74)	3.70 (R-21)
WINDOWS	1.19 (U-0.21)	1.50 (0.27)
EXTERIOR DOORS	1.19 (U-0.21)	2.17 (U-0.38)

